

File Number:	Roll Number:
Location of Property: <i>635 Douro 8th Line</i>	
Owner (s) Name: <i>John Coughlin</i>	
Phone Number: <i>705-931-0929</i>	

**Severed**

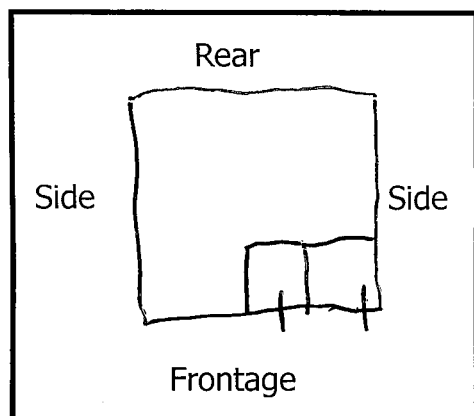

Street/Road Name:	<i>Douro 8th Line</i>	
Safe Entrance Possible:	Yes <input checked="" type="checkbox"/>	No <input type="checkbox"/>
Culvert Required when lot developed:	Yes <input checked="" type="checkbox"/>	No <input type="checkbox"/>
3 metre strip of frontage from severed parcel required:	Yes <input checked="" type="checkbox"/>	No <input type="checkbox"/>
Other Requirements (i.e. fill, brushing, etc.):		

**Retained** (if vacant)

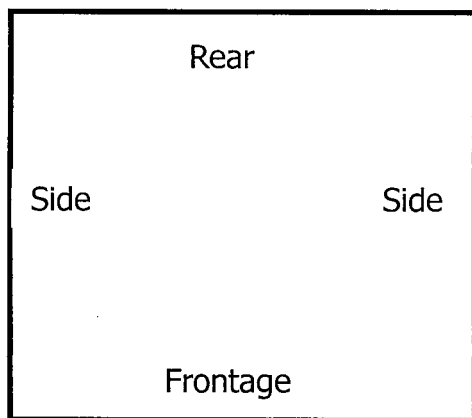

Street/Road Name:	<i>Douro 8th Line</i>	
Safe Entrance Possible:	Yes <input type="checkbox"/>	No <input type="checkbox"/>
Culvert Required when lot developed:	Yes <input type="checkbox"/>	No <input type="checkbox"/>
3 metre strip of frontage from severed parcel required:	Yes <input type="checkbox"/>	No <input type="checkbox"/>
Other Requirements (i.e. fill, brushing, etc.):		

**Additional Comments:** *Minor brushing to achieve site lines - Minor ditching for drainage.*

Date Site Visited: *May 21, 2020*

Owner Present: Yes ☐ No ☒

*[Signature]*  
Jake Condon  
Temporary Manager of Public Work

Owner's Acknowledgement

File Number:	Roll Number:
Location of Property: <i>635 Douro 8th Line</i>	
Owner (s) Name: <i>John Laughlin</i>	
Phone Number: <i>705-931-0929</i>	

**Severed**

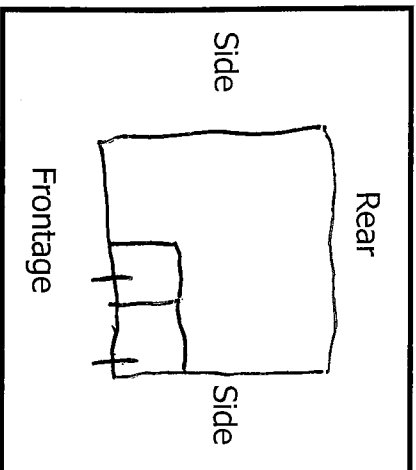

Street/Road Name:	<i>Douro 8th Line</i>
Safe Entrance Possible:	Yes <input checked="" type="checkbox"/> No <input type="checkbox"/>
Culvert Required when lot developed:	Yes <input checked="" type="checkbox"/> No <input type="checkbox"/>
3 metre strip of frontage from severed parcel required:	Yes <input checked="" type="checkbox"/> No <input type="checkbox"/>
Other Requirements (i.e. fill, brushing, etc.):	

**Retained** (if vacant)

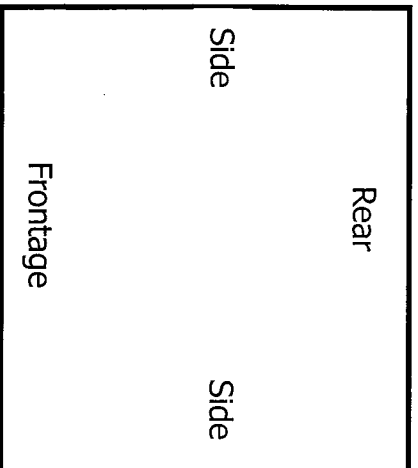

Street/Road Name:	<i>Douro 8th Line</i>
Safe Entrance Possible:	Yes <input type="checkbox"/> No <input type="checkbox"/>
Culvert Required when lot developed:	Yes <input type="checkbox"/> No <input type="checkbox"/>
3 metre strip of frontage from severed parcel required:	Yes <input type="checkbox"/> No <input type="checkbox"/>
Other Requirements (i.e. fill, brushing, etc.):	

**Additional Comments:** *Minor brushing to achieve site lines - Minor ditching for drainage.*

Date Site Visited: *May 21, 2020*

Owner Present: Yes ☐ No ☒

*Jake Condon*  
Temporary Manager of Public Work

Owner's Acknowledgement