

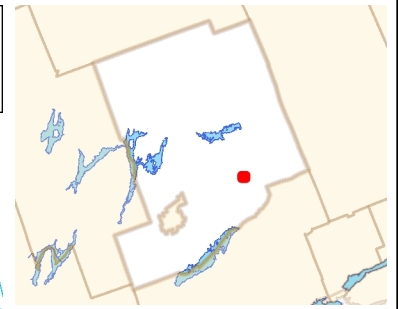

County of  
Peterborough

**B-28-92**

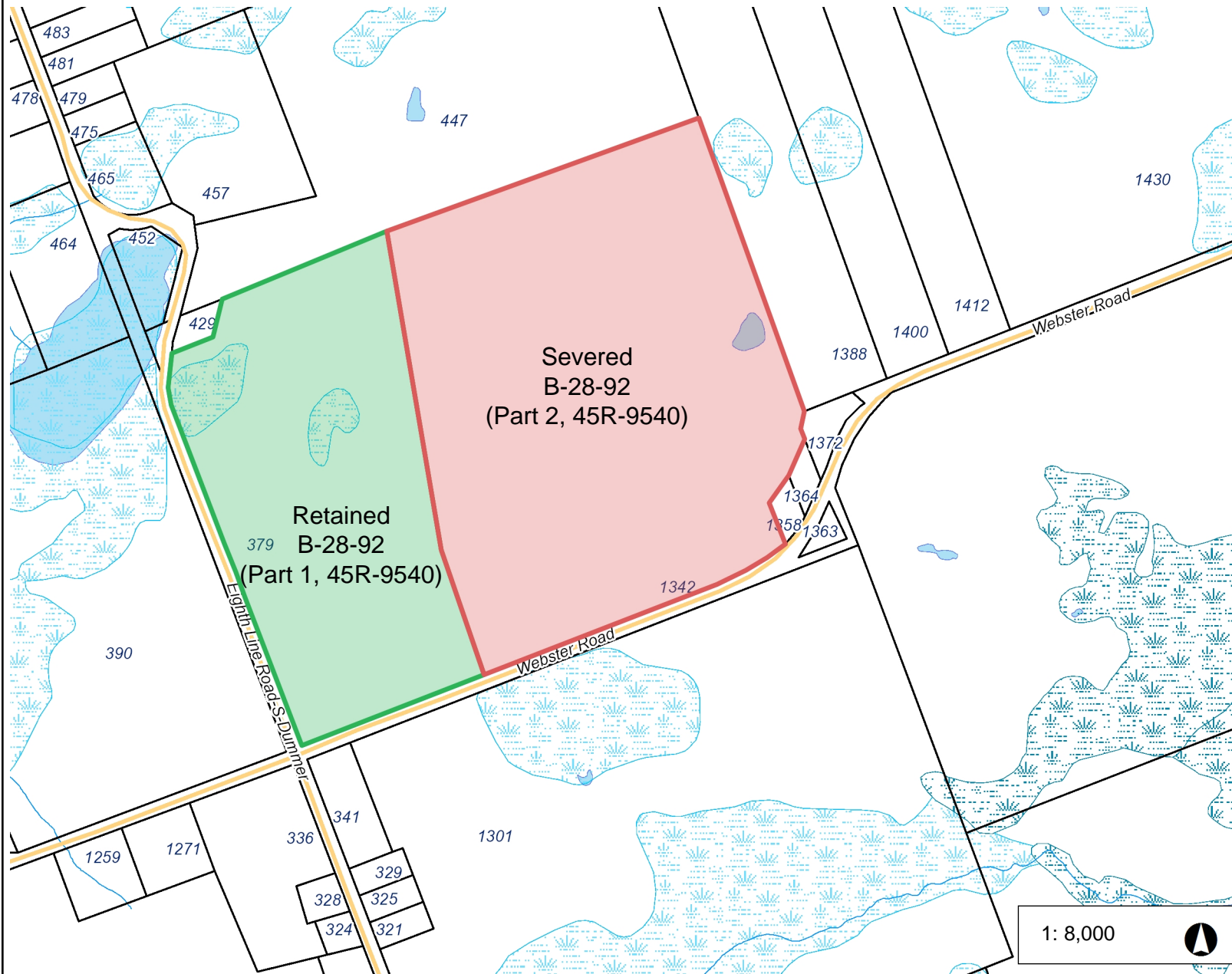

### Legend

- Hydro Lines
- Roads < 50,000
  - PRIV ; Private; PRIV
  - City Arterial
  - City Collector and Local
  - City Owned Unclassified
  - Provincial
  - County
  - Township
  - Water Access Only
- Outside Roads < 50,000
  - Major Roads
  - Local Roads
- Peterborough Proposed Bypass
- First Nations
- Civic Address
- Parcel Fabric
- Parcel First Nations - Canada I
- Rivers
  - Intermittent
  - Permanent
- Clean Water Act Policies Apply
- Provincially Significant Wetland
- Locally Significant Wetlands
- Non-evaluated Wetlands
- Lakes - Local Scale
- Municipal Boundary - Upper Ti
- <all other values>

1: 8,000



406.4 0 203.20 406.4 Meters

North\_American\_1983\_CSRS\_UTM\_Zone\_17N  
© Latitude Geographics Group Ltd.

This map is a user generated static output from an Internet mapping site and is for reference only. Data layers that appear on this map may or may not be accurate, current, or otherwise reliable.

THIS MAP IS NOT TO BE USED FOR NAVIGATION

### Notes

Severed (1342 Webster Road)  
Retained (379 Eighth Line  
Road-S-Dummer)