

Amendment No. 72
to the
Official Plan of the
County of Peterborough

Kevin M. Duguay Community Planning and Consulting Inc.
for Sylvia and David Robinson
1110 County Road 4, Douro-Dummer
Part Lot 10, Concession 3, Douro Ward

Part B - The Amendment

All of this Part of the document entitled Part B - The Amendment consisting of the following text and schedule constitutes Amendment No. "72" to the Official Plan of the County of Peterborough.

Details of the Amendment

The Official Plan of the County of Peterborough is hereby amended as follows:



1. Schedule 'A4-1' Land Use and Transportation Plan , Douro Ward of the Official Plan of the Township of Douro-Dummer within the Official Plan of the County of Peterborough, is amended by redesignating a portion of the property located at Part of Lot 10, Concession 3, in the Geographic Township of Douro, in the Township of Douro-Dummer, from the "Extractive Industrial" designation to the "Rural" designation as shown on Schedule '1' attached hereto and forming part of this Amendment.

Implementation and Interpretation

The implementation and interpretation of Official Plan Amendment No. 72 shall be in accordance with the respective policies of the Official Plan of the County of Peterborough, as amended.

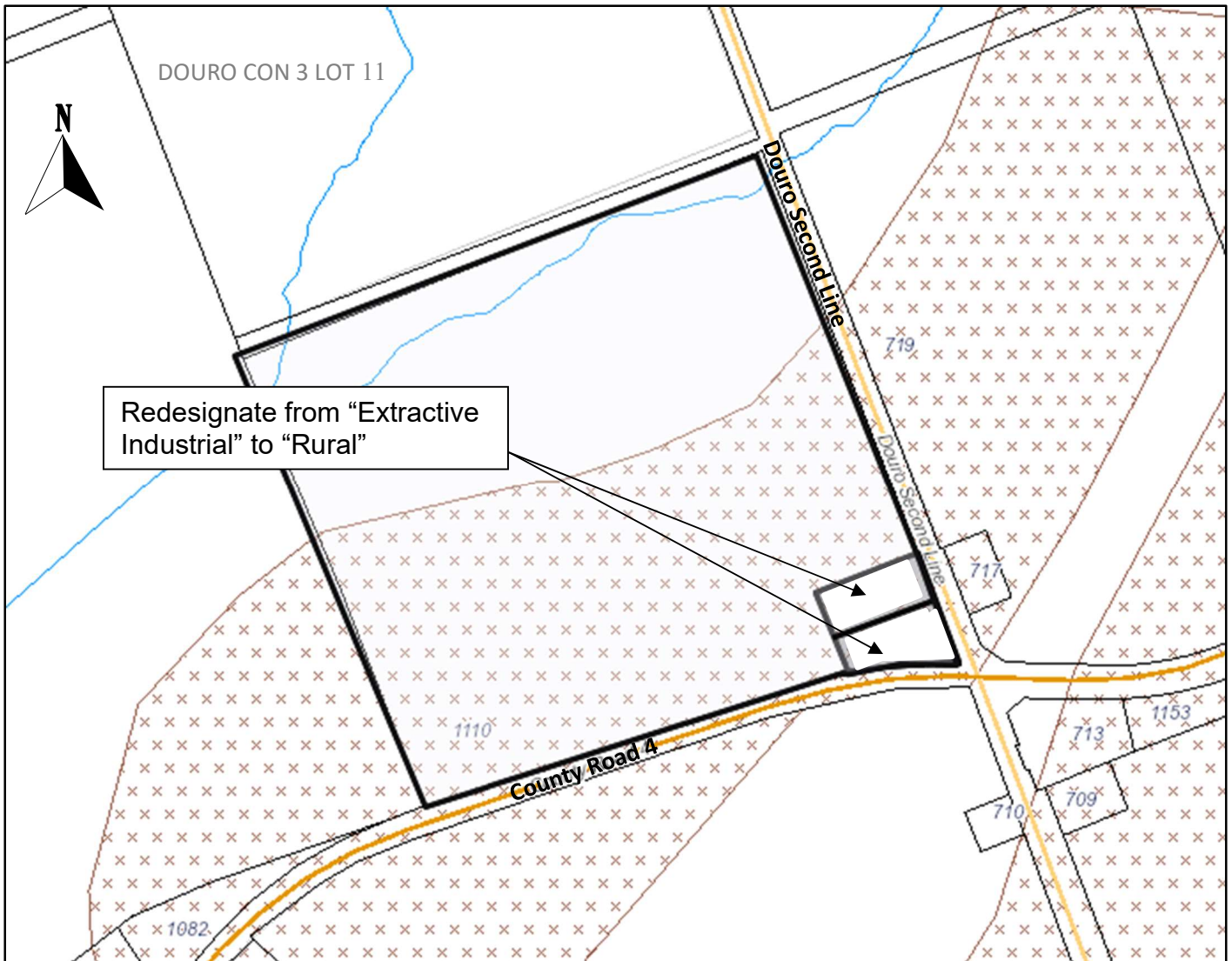
Schedule '1'
To
Official Plan Amendment No. 72
County of Peterborough Official Plan



-  Extractive Industrial
-  Rural

Part C - The Appendices

The following appendices do not constitute part of Official Plan Amendment No. 68, but are included as information supporting the Amendment.

- **Appendix No. 1 Correspondence**
- **Appendix No. 2 Public Meeting Notice**
- **Appendix No. 3 Public Comments**
- **Appendix No. 4 Agency Comments**

Appendix No. 1 – Correspondence

None.