

**Roll # 1522-020-001-08200**  
Revised Location  
Lot 4, Concession 5, Dummer Ward

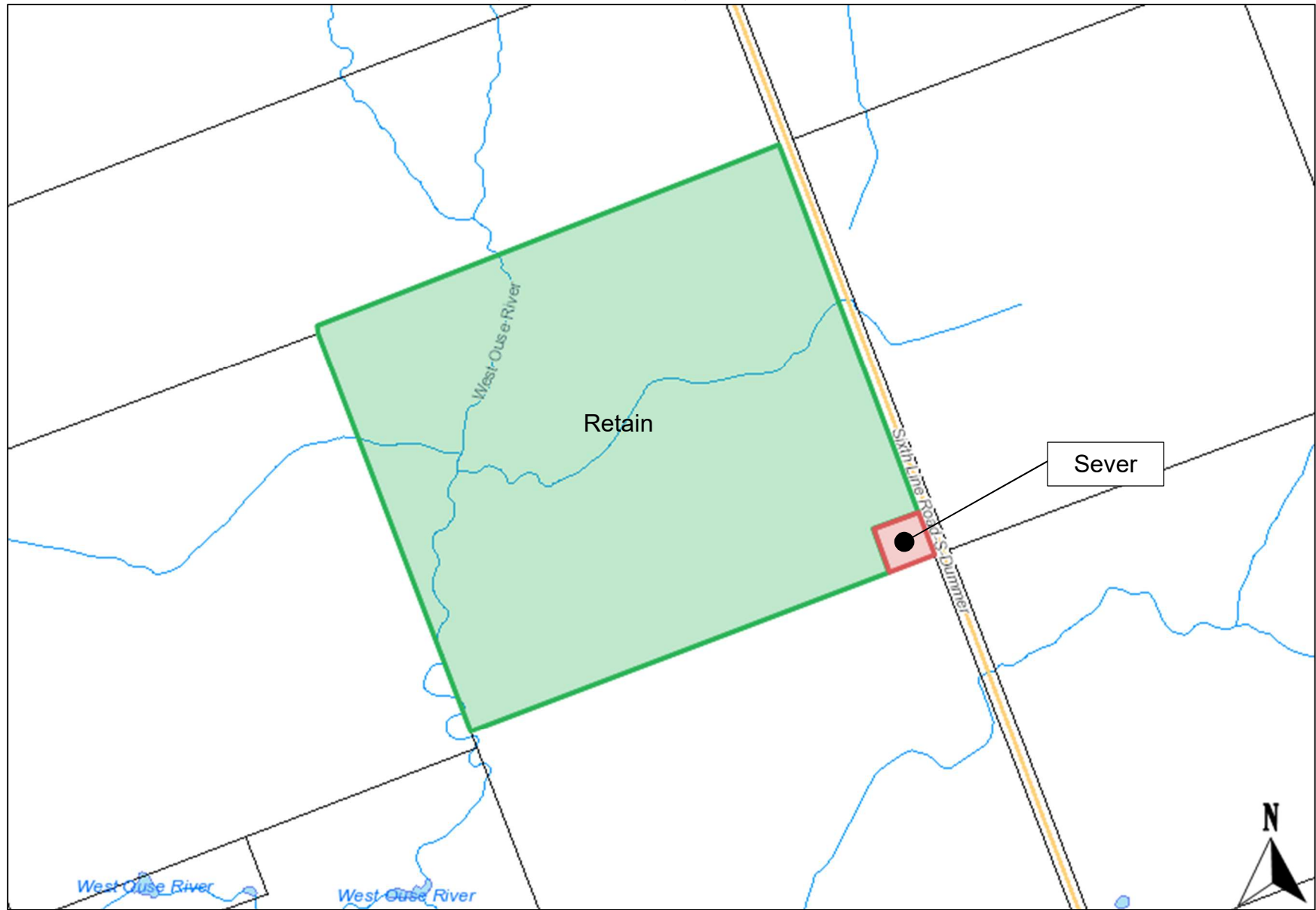

**Scale (metric)**  
1:8,000

**Roll # 1522-020-001-08200**  
**Special Features Mapping: Key Hydrologic Features**

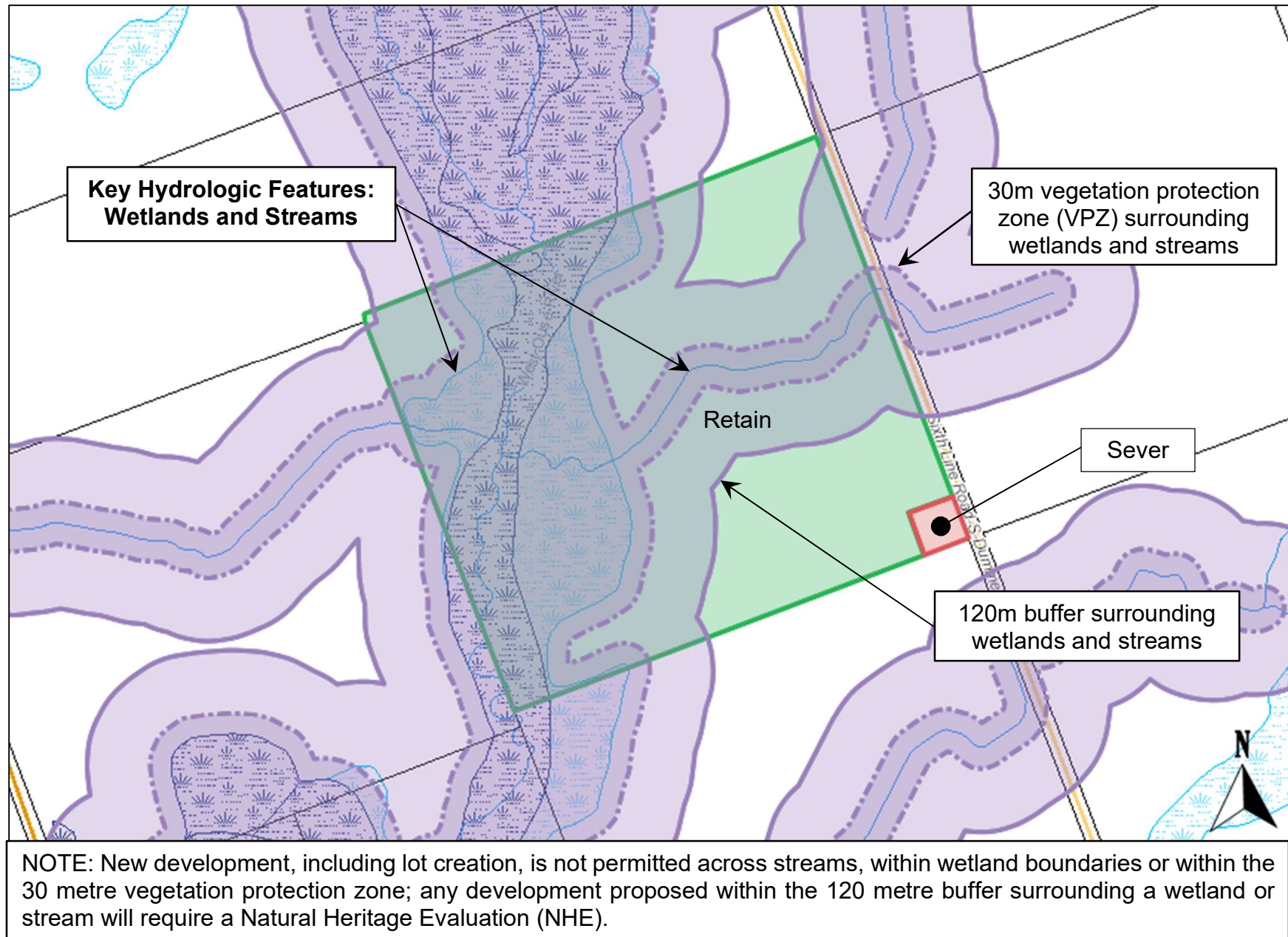

**Scale (metric)**  
1:8,000

**Roll # 1522-020-001-08200**  
**Minimum Distance Separation (MDS) Requirements**

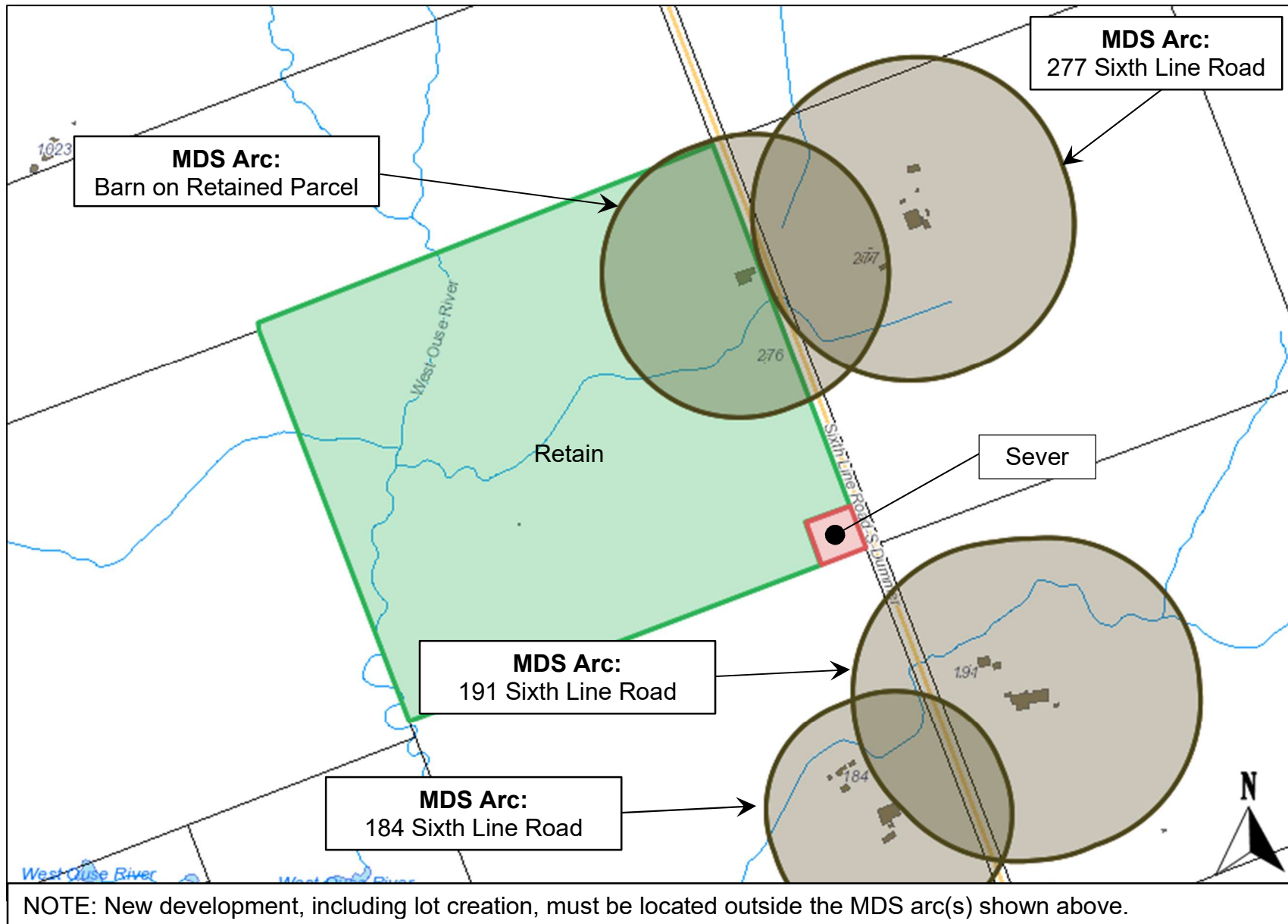

**Scale (metric)**  
1:8,000

**Roll # 1522-020-001-08200**  
**Special Features Mapping – Species at Risk**

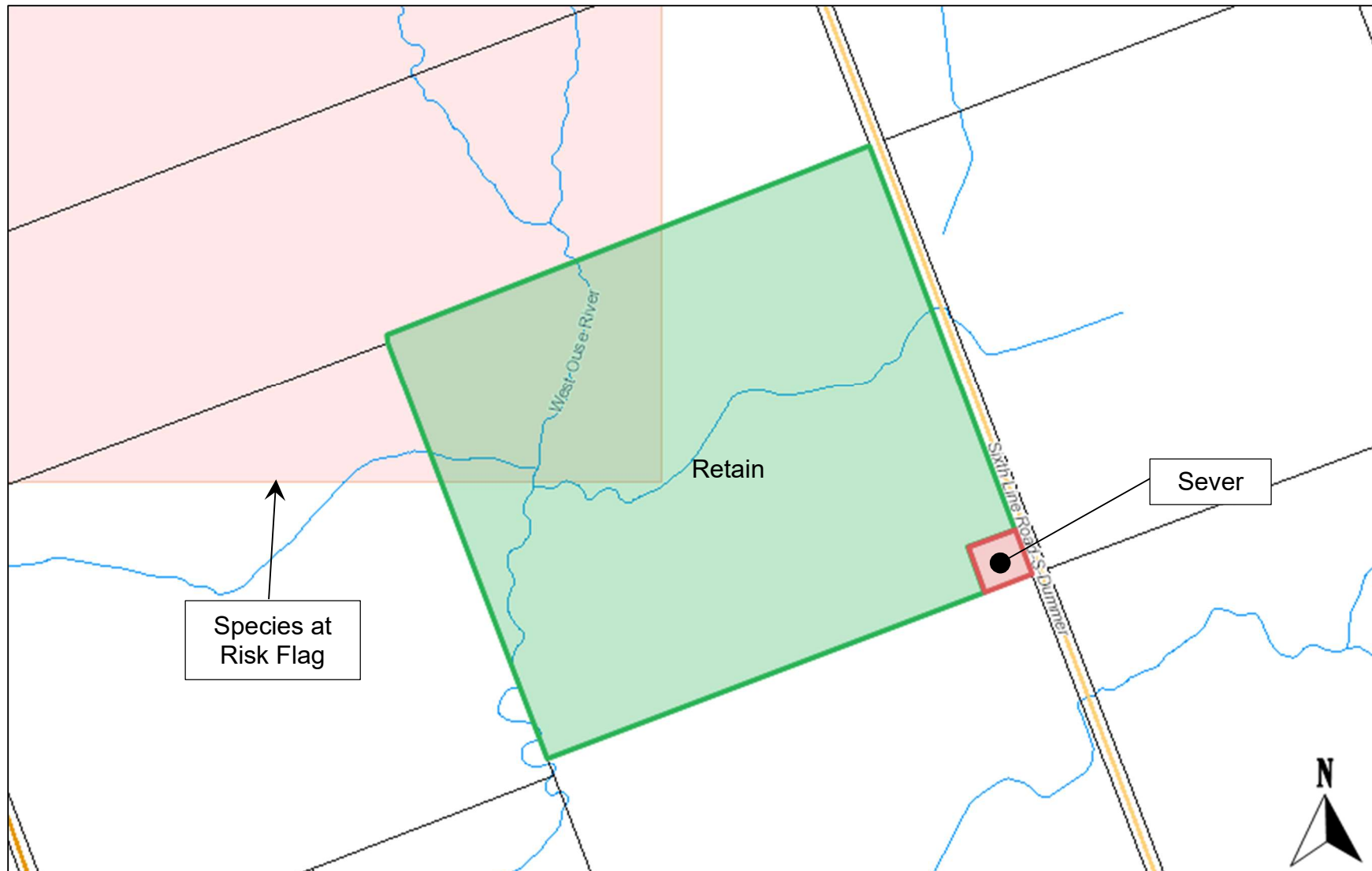

NOTE: New development, including lot creation, is not permitted within habitat of threatened and endangered species, except in accordance with provincial and federal requirements. Species at Risk Data available to the County has identified an observation or potential habitat that may require a Species at Risk (SAR) Assessment to support the severance application.

**Scale (metric)**  
1:8,000